

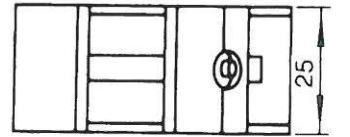

Mini Tool Maker Vise

ORDER NO.VMV-10 CODE NO.2003-001

WEIGHT:0.3kg

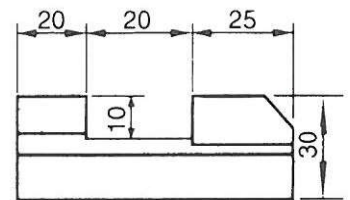
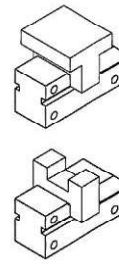
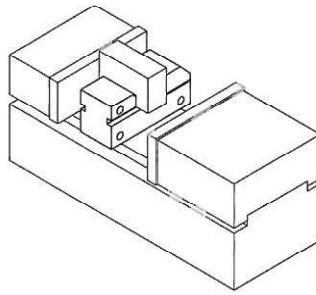
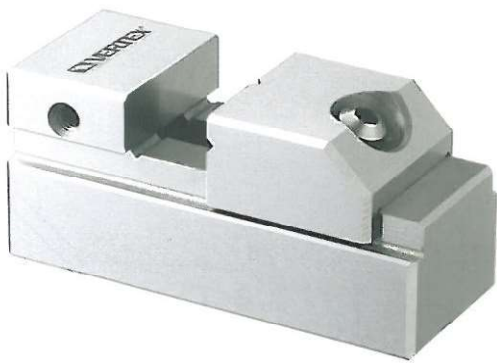

Tool makers vise of mini type which can be put in a bigger vise to process the small and precise workpiece. Also it can be used in an E.D.M. machine and grinding machine.

Squareness and parallelism : within ± 0.005 mm / 100 mm.

ORDER NO.	Weight (kgs)	CODE NO.
VMV-10	0.3	2003-001



Tool Maker Vise

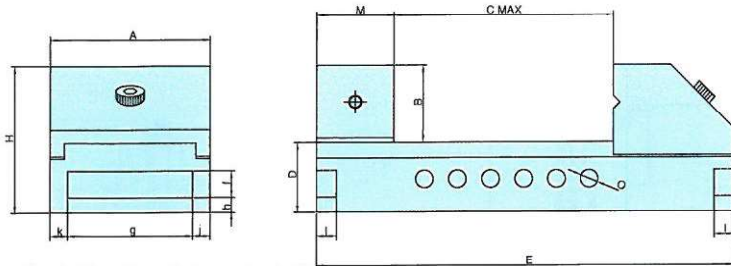
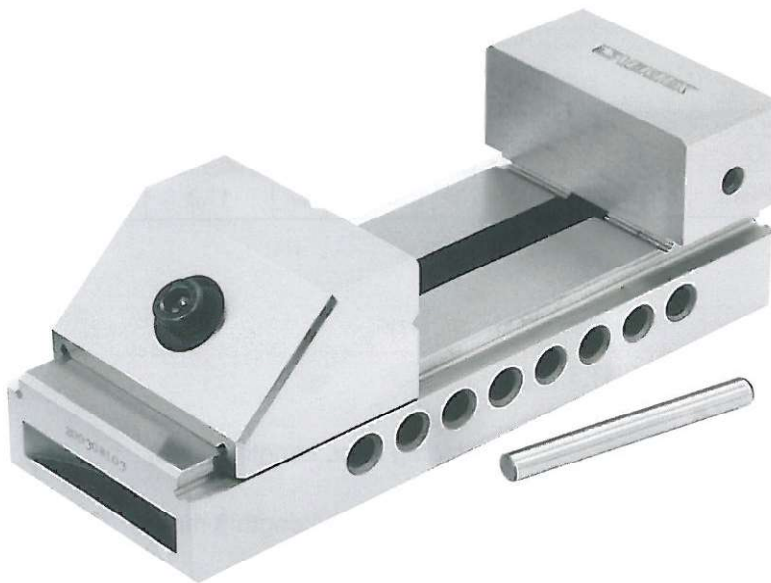

- Made of SK material of J.I.S. specification.
- Hardened by heat treatment and precision ground.
- Squareness and parallelism are ensured to be within ± 0.005 mm / 100 mm.
- It can be used and kept its high precision while standing on its base, sides or extremity, for inspection use in stead of squares due to its extremely accuracy.
- Hardness: HRC $54^{\circ} \pm 2^{\circ}$

ORDER NO.	MATERIAL	A	B	C max	D	E	I	f	g	h	j	k	H	M	O	N.W (KGS)	CODE NO
VMV-15	SK2	36	20	40	20	100	5	8	24	5	6	6	40	20	6	0.9	2003-010
VMV-20	SK2	47	29	74	28	150	5	10	37	6	5	5	57	30	8	2	2003-011
VMV-25	SK2	62	34	89	28	170	7	10	52	6	5	5	62	30	8	3.3	2003-012
VMV-30	SK2	72	34	99	32	190	9	12	56	7	8	8	66	35	8	4.5	2003-013
VMV-35	SK2	88	45	120	40	225	12	12	64	11	12	12	85	40	10	7	2003-014
VMV-40	SK2	98	45	125	40	230	12	12	64	11	17	17	85	40	10	8.9	2003-015
VMV-50	SK2	125	50	157	50	287	12	13	73	14	26	26	100	50	14	15.5	2003-016
VMV-60	S50C	150	50	200	50	330	12	14	76	14	37	37	100	50	14	21.4	2003-017

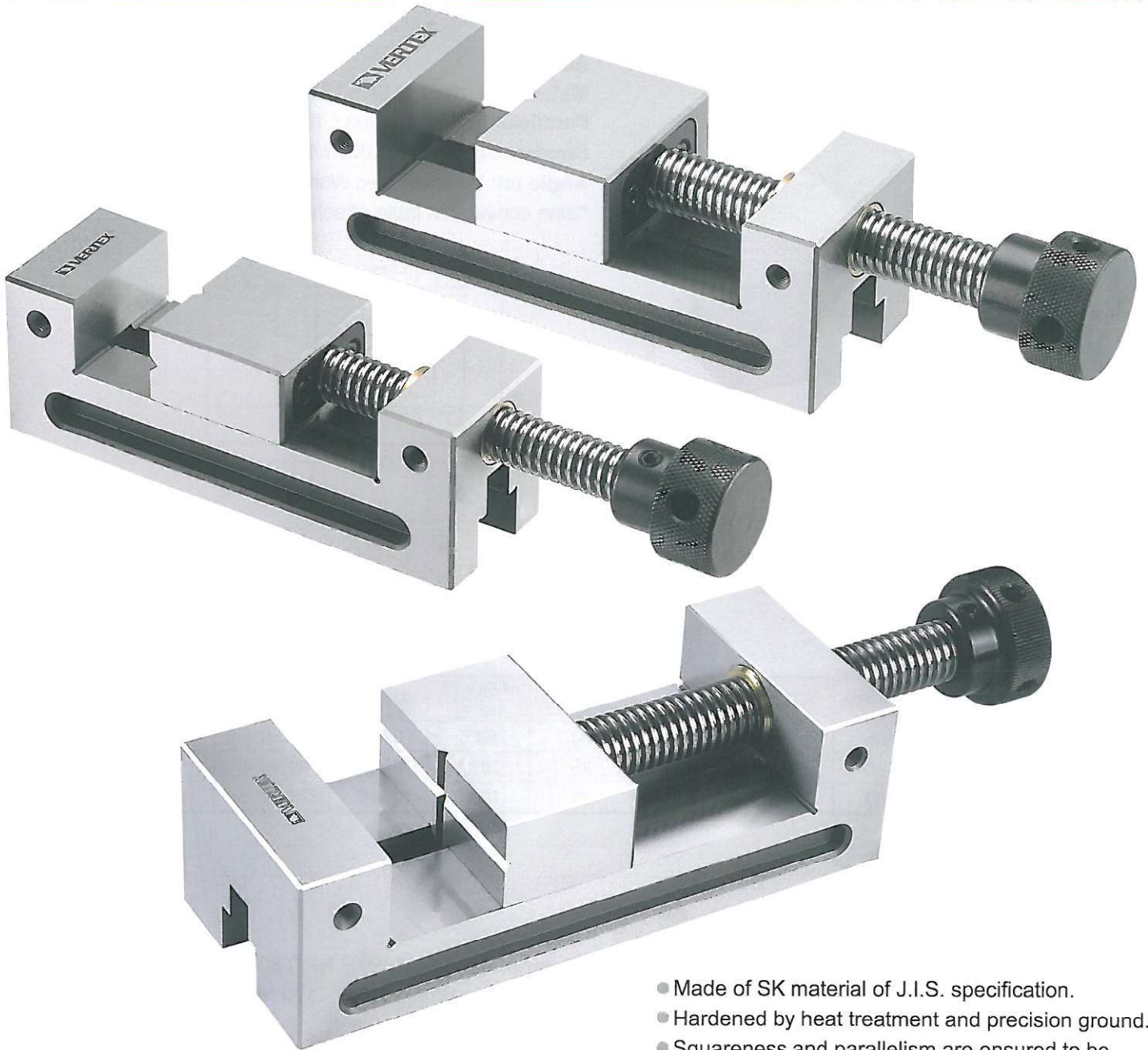

- Made of SK material of J.I.S. specification.
- Hardened by heat treatment and precision ground.
- Squareness and parallelism are ensured to be within ± 0.005 mm / 100 mm.
- It can be used and kept its high precision while standing on its base, sides or extremity, for inspection use in stead of squares due to its extremely accuracy.
- Hardness: HRC $54^{\circ} \pm 2^{\circ}$

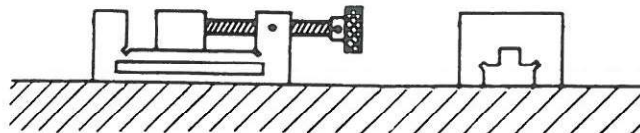
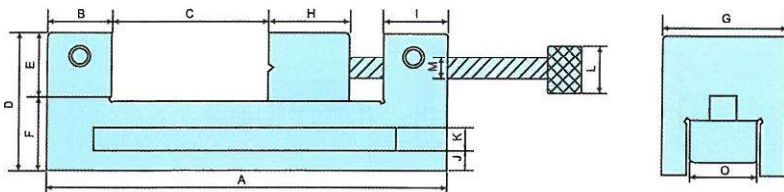

TOLERANCE ± 0.005 mm / 100mm

Unit:mm

ORDER NO.	MATERIAL	A LENGTH	B	JAW C OPENING	D	E	F	G	H	I	J	K	L	M	O	HEIGHT (mm)	HARDEN	WEIGHT (KGS)	CODE NO.
VDV-20	SK2	154	25	55	54	24	29	47	45	25	9.50	10.15	34.70	15.80	18.7	54	HRC54 $\pm 2^{\circ}$	2.5	2003-020
VDV-25	SK2	175	25	75	60	29	30	62	44.80	25	10	10.90	39.60	18.95	26	60	HRC54 $\pm 2^{\circ}$	3.9	2003-021
VDV-30	SK2	180	30	71	70	29	40	72	51.85	25	14	12.35	50.35	18.95	26	70	HRC54 $\pm 2^{\circ}$	5.7	2003-022
VDV-35	SK2	250	35	121	73	38	35	88	55.40	35.55	10.80	11.60	54.85	25.35	30.20	73	HRC54 $\pm 2^{\circ}$	9.2	2003-023
VDV-40	SK2	250	35	121	73	38	35	98	55	34.75	11.80	11.55	54.65	25.35	29.60	73	HRC54 $\pm 2^{\circ}$	10.1	2003-024

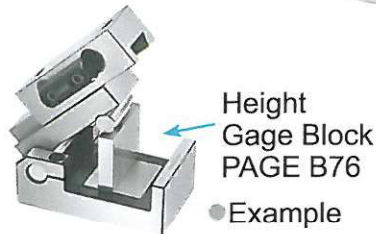

- Compound angles easily and quickly set.
- Adjustments up to 46 degrees.

Accuracy :

Material Hardened: SKS HRC 60° Sub-zero processing.

Parallelism: Within 0.003 / 100 mm

Squareness: Within 0.005 / 100 mm

Angle tol: Within 15 sec Within 20 sec

*Sine conversion table attached page B16

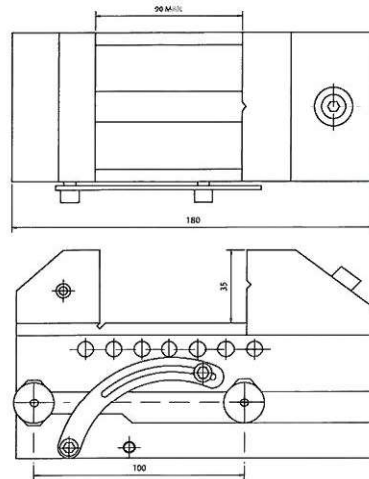

SPECIFICATION

Unit:mm

ORDER NO.	MATERIAL	LENGTH	WIDTH	JAW OPENING	JAW HEIGHT	HEIGHT (mm)	ANGLE	HARDEN	N.W (KGS)	CODE. NO.
SVB-20	SK2	155	48	80	30	93.5	0°-46°	HRC56°-58°	4.4	2003-030
SVB-25	SK2	175	63	90	35	102.5	0°-46°	HRC56°-58°	6	2003-031
SVB-30	SK2	180	73	90	35	103.8	0°-46°	HRC56°-58°	6.9	2003-032

Sine Vise

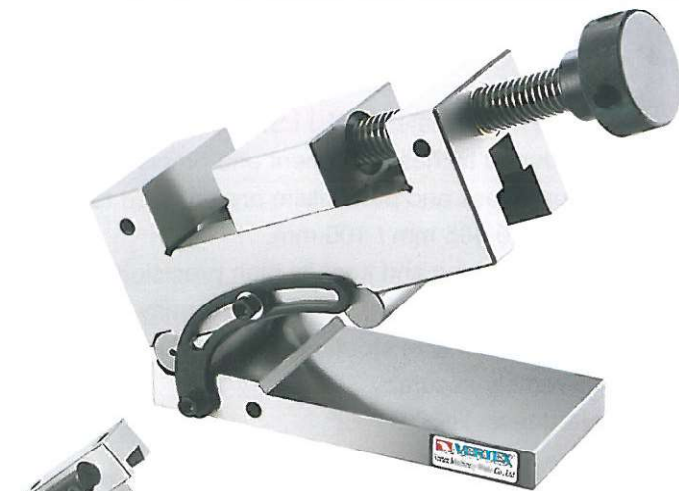

- Compound angles easily and quickly set.
- Adjustments up to 46 degrees.

Accuracy :

Material Hardened: SKS HRC 60° Sub-zero processing.

Parallelism: Within 0.003 / 100 mm

Squareness: Within 0.005 / 100 mm

*Sine conversion table attached page B16

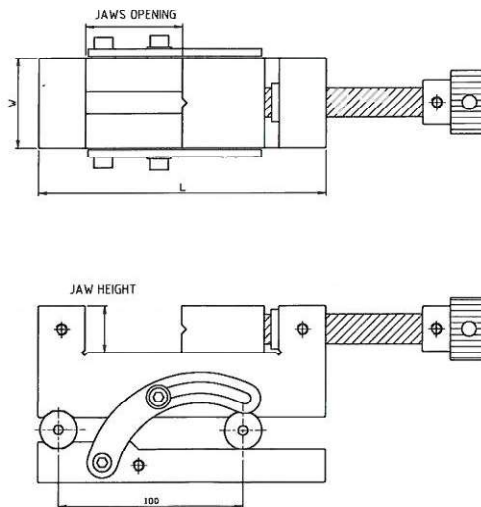

SPECIFICATION

Unit:mm

ORDER NO.	MATERIAL	LENGTH	WIDTH	JAW OPENING	JAW HEIGHT	HEIGHT (mm)	ANGLE	HARDEN	N.W (KGS)	CODE. NO.
SVD-200	SK2	155	48	60	25	94	0°-46°	HRC54°±2	4.6	2003-040
SVD-250	SK2	176	63	68	30	97.5	0°-46°	HRC54°±2	6.4	2003-041
SVD-300	SK2	180	73	72	30	103	0°-46°	HRC54°±2	8.4	2003-042

Good Design With High Precision And Rigid

Accuracy :

Material Hardened: SKS HRC 60° Sub-zero processing.

Parallelism: Within 0.003 / 100 mm

Squareness: Within 0.005 / 100 mm

Angle tol: Within 15 sec Within 20 sec

Material: SKS2

*Sine conversion table attached page B16

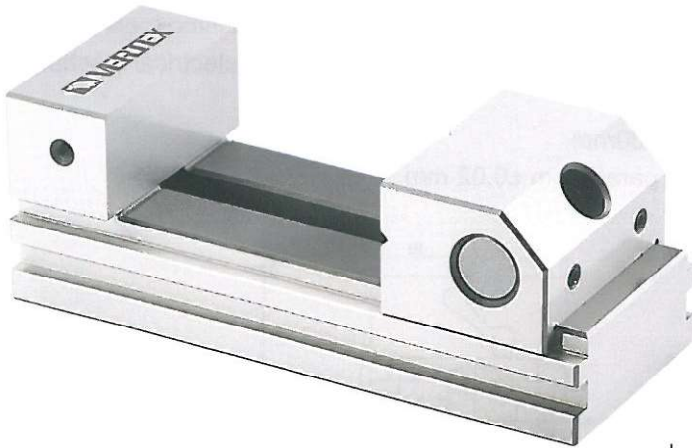

Fixed Down Jaw Designed

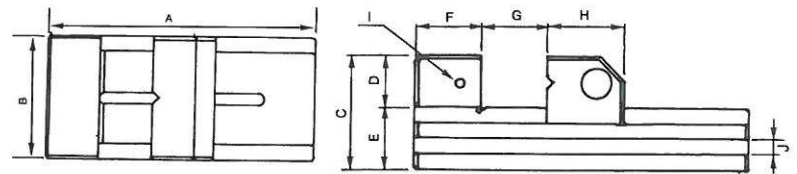

ORDER NO.	A	B	C	D	E	F	G	H	I	J	N.W (kgs)	CODE NO.
VC20	150	48	53	25	28	25	84	40	M6	8	1.6	2003-070
VC25	176	63	59	30	29	30	95	48	M6	8	2.8	2003-071
VC30	190	73	68	35	33	35	100	53	M6	9	4	2003-072
VC40	245	98	90	45	45	45	135	65	M8	12	9.02	2003-073

TOOL MAKER VISE

Tool Makers Vise

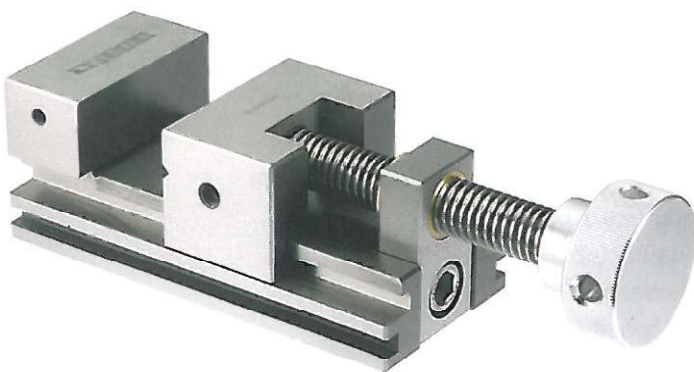

Accuracy :

Material Hardened: Sub-zero processing.

Parallelism: Within 0.003 / 100 mm

Squareness: Within 0.005 / 100 mm

Angle tol: Within 15 sec Within 20 sec

Material: SKS2

Hardness: HRC 54°±2°

*Sine conversion table attached page B16

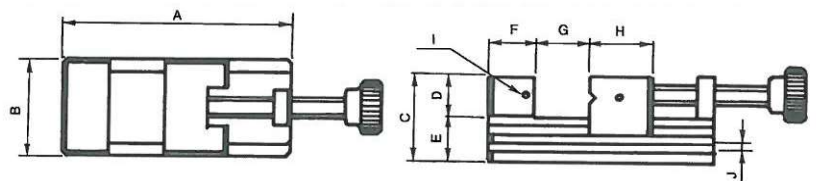

ORDER NO.	A	B	C	D	E	F	G	H	I	J	N.W (kgs)	CODE NO.
V-VE20	90	60	50	23	27	25	32	30	M5	6x6	1.62	2003-080
V-VE25	160	70	62	28	34	33	80	45	M6	7.5x7	4.02	2003-081
V-VE30	175	73	65	30	35	35	93	45	M6	7.5x7	4.7	2003-082