



# Horizontal Moving Quick Vise



## 2 WAY MOVING

- Special design, for milling M/C, drilling M/C.
- Easy & quick to find process position.
- For round table drilling machine. If it don't have cross table.
- 360° rotation

**NEW**

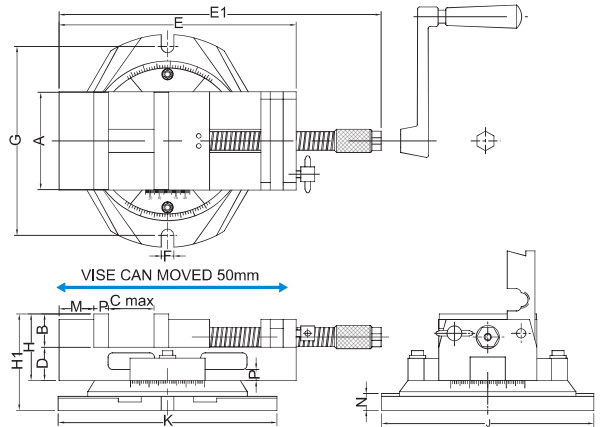
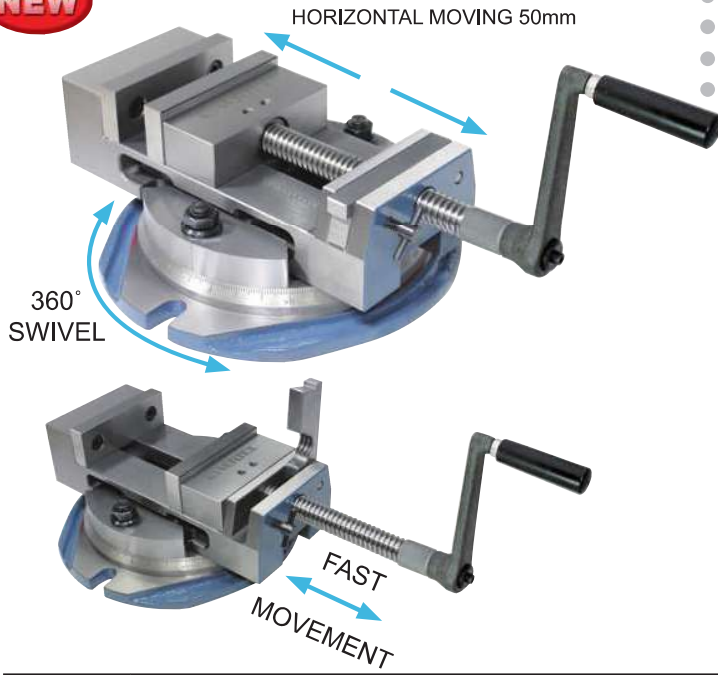

<b>FAST MOVE</b>	<b>ACCURACY GUARANTEE</b> 0.02/100 MM 0.02/50	<b>TABLE HARDNESS</b>	<b>BENDING PROOF</b>	<b>MECHANICAL</b>	<b>patent PAT.</b>
------------------	--	-----------------------	----------------------	-------------------	--------------------

ORDER NO.	A	B	C max.	D	E	E1	F	G	H	H1	J	K	M	N	P	MAX.Clamp Force kgf	G.W.	CODE NO.
VQW-80	81	34	85	36	230	374	14	214	70	100	242	230	28	30	12	700	13.5	1002-245
VQW-100	105	36	104	36	256	422	16	264	72	106	303	272	37	34	16	800	15.8	1002-246
VQW-130	131	36	125	38	297	490	16	264	74	108	303	272	38	34	29	800	22.7	1002-247



# Quick Setting Vise



## Features

- Special design for quick clamping. (From the acme thread shaft stationly)
- Quick setting by sliding movement. Big clamping capability.
- Operating very quick and easy, can increase so much working efficiency than you can image.
- Good for short term and massive production or proto type work.
- Suit for milling machine, grinder machine, precision drilling machine using.
- Accurate grounded and assembled.
- Precision cut acme thread, it can get 800kgs high clamping force.
- Horizontal & vertical
- Accuracy 0.02 / 100 mm

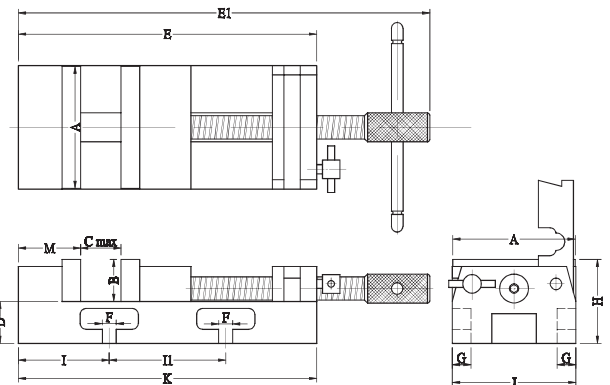
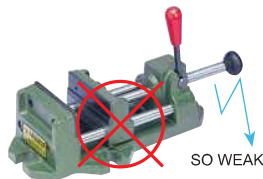

<b>FAST MOVE</b>	<b>ACCURACY GUARANTEE</b> 0.02/100 MM 0.02/50	<b>TABLE HARDNESS</b>	<b>BENDING PROOF</b>	<b>MECHANICAL</b>	<b>patent PAT.</b>
------------------	--	-----------------------	----------------------	-------------------	--------------------

ORDER NO.	A	B	C max.	D	E	E1	F	G	H	I	H1	J	K	M	MAX.Clamp Force kgf	G.W.	CODE NO.
VQS-3	81	34	85	36	230	374	10	14	70	75	80	82	230	50	700	7	1002-262
VQS-4	105	36	104	36	256	422	12	16	72	78	100	106	256	54	800	9.5	1002-263
VQS-5	131	36	125	38	297	490	12	20	74	98	100	132	297	67	800	14.5	1002-264



# Machine Vise For Shaping & Milling Use

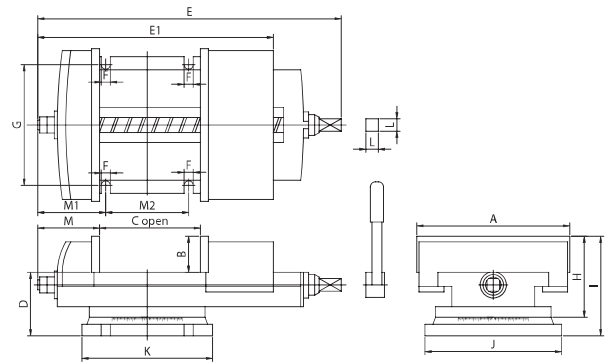

The vise is made of the high tension cast iron, rigidity, large range of clamping spans and more bigger clamping force at press down jaws, especially suitable for the heavy duty cutting and the heavy duty planner milling machine to clamp large workpiece.

Unit:mm

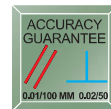

ORDER NO.	A	B	C OPEN	D	E	E1	F	G	H	I	J	K	L	M	M1	M2	Max. Clamp Force (kgf)	G.W. (kgs)	CUFT (cm)	CODE NO.
VSM-12	304	72	290	126	604	560	18	240	161	198	272	260	25	123	135	165	800	84	67x35x23	1002-270
VSM-16	405	96	415	145	763	738	20	292	200	241	336	336	25	135	143	248	1000	142	84x45x27	1002-271
VSM-20	508	95	505	150	902	871	21	288	204	245	336	336	25	169	211	246	1200	200	97x56x28	1002-272



## B-Type Milling Vise

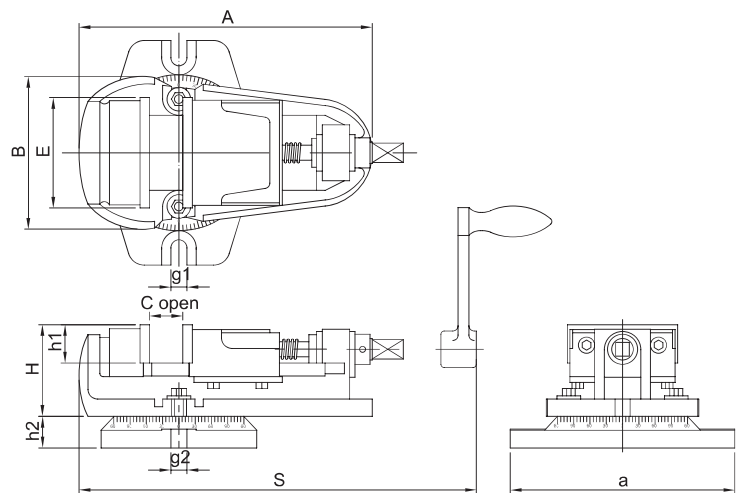

- A wider bottom to increase clamping force.
- Groove device to collect cutting oil.
- Full 360° swivel base with line, accurate graduation.
- In order to ensure the accuracy when using it better that don't put swivel base together

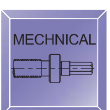
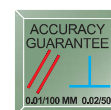

ORDER NO.	A	B	E	H	C OPEN	S	a	h1	h2	g1	g2	Max. Clamp Force (kgf)	G.W. kgs	CODE NO.
VBV-4	270	140	100	79	65	305	212	33	28	12	12	900	13	1002-280
VBV-5	350	180	125	96	100	410	280	37	35	15	15	900	21.5	1002-281
VBV-6	452	218	160	103	132	483	317	48	40	16	16	1000	41	1002-282

# Super Open Drill Vise



EURO TYPE

**NEW**

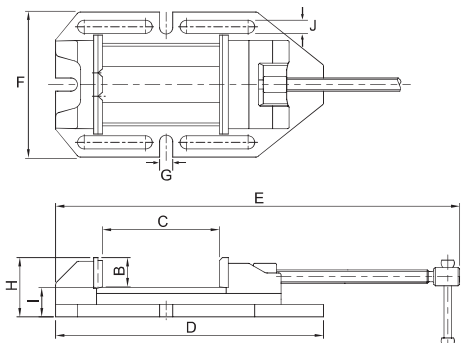

- Big opened.
- Big clamping capacity.
- With prisma jaw for round workpiece.
- For drilling & milling using.

Unit:mm

ORDER NO.	A	B	C OPEN	D	E	F	G	H	I	J	V	MAX.Clamp Force kgf	G.W. (kgs)	CFT (cm)	CODE NO.
VRV-4	110	32	130	316	471	179	16	73	40	16	5-32	450	9.8	32.3 x 13.3 x 12.9	1002-320
VRV-5	135	40	160	366	552	207	16	81	40	16	6-40	650	14.0	32.3 x 13.3 x 12.9	1002-321
VRV-6	160	50	220	447	693	247	16	96	45	16	7-48	900	25.7	32.3 x 13.3 x 12.9	1002-322

# Free Vise

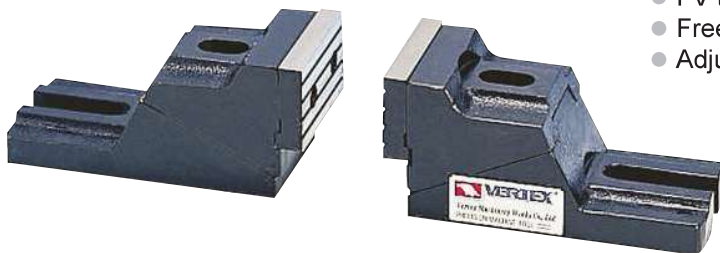

- FV type is light duty.
- Free style clamping For big workpiece.
- Adjustable distance 15mm For clamping.

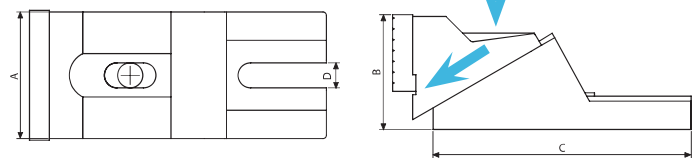

Unit:mm

ORDER NO.	DIMENSION (WxHxL)	CLAMPING CAPACITY (HxL)	ACCESSORIES BOLT SIZE	MAX.Clamp Force kgf	WEIGHT (kgs/2PCS)	CODE NO.
FV-350	75x67x150mm	140x350mm	M12 x 75L x 2PCS. M12 x 125L x 2PCS	900	7,5	1002-290
FV-450	100x90x200mm	180x450mm	M12 x 75L x 2PCS. M12 x 125L x 2PCS	900	14	1002-291
FV-550	125x120x250mm	250x550mm	M16 x 75L x 2PCS. M16 x 125L x 2PCS	900	23	1002-292

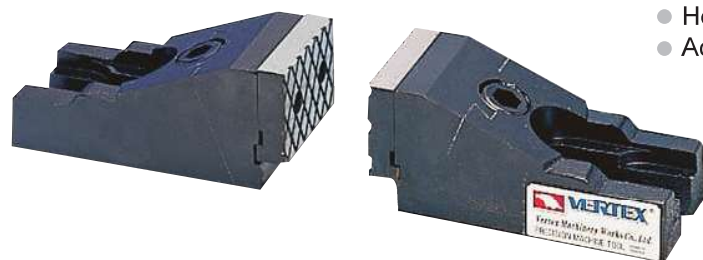

- Free style clamping For big workpiece.
- Heavier duty.
- Adjustable distance 10mm For clamping.

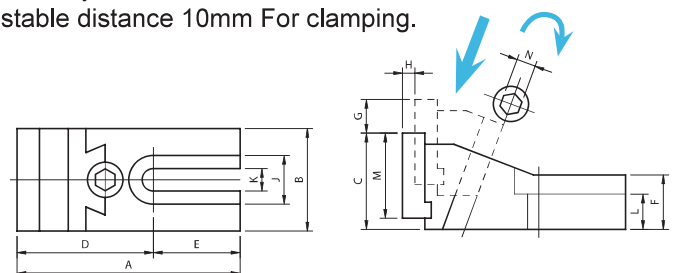

Unit:mm

ORDER NO.	A	B	C	D	E	F	G	H	J	K	L	M	N	MAX.Clamp Force kgf	ACCESSORIES BOLT SIZE	N.W. (kgs)	CODE NO.
SV-62	139	64	59.5	85	54	33.5	21	9	30.5	18	22	52.5	12	1800	M12 x 75L x 4PCS	5,8	1002-293
SV-85	192	86.5	86	115	77	53	24	10	36	18	25.5	59.5	12	1800	M16 x 75L x 4PCS	11	1002-294
SV-125	218	127	84	124	94	51.5	33	18	45.5	20	23.5	73	12	1800	M16 x 75L x 4PCS	21	1002-295



# Drill Vise



NEW

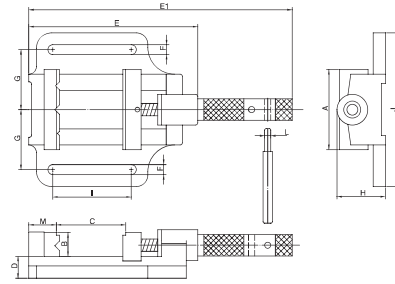

- Designed with solid structure, main body is made of FC15, assemble a pair of heat treated steel jaws with hardness HRC 45°~50°
- Suitable for clamping work piece on drill press machine & milling machine
- Jaw pair and handle are surface treated by black oxide finish
- Front fixed prismatic jaw with cross V-grooves is designed for clamping work piece firmly in both vertical & horizontal directions

ORDER NO.	A	B	C OPEN	D	E	E1	F	G	H	I	J	L	M	WEIGHT	CODE NO.
DV-85	84	25	85	27	182	287	12	64	56	80	167	8	32	3.5	1015-041
DV-100	104	31	100	28.5	220	343	13	78	63	102	200	8	36	5.7	1015-042
DV-120	132	38	120	32	250	395	14	91	71	127	226	9.5	45	8.2	1015-043



# Steel Bench Vise With Base

NEW



360° SWIVING BASE

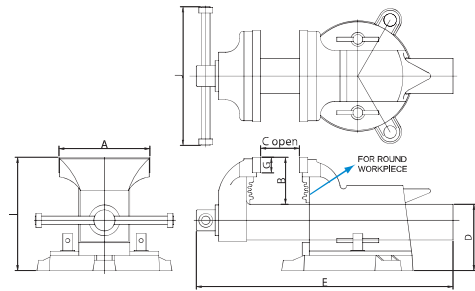

ORDER NO.	A	B	C OPEN	D	E	G	I	J	Clamp Force (kgf)	WEIGHT (kgs)	CODE NO.
BVV-3	79	51	75	87	280	18	138	178	1300	6	1002-330
BVV-4	104	61	100	87	310	18	148	178	1800	7	1002-331
BVV-5	127	68	125	93	370	22	165	198	2300	10.5	1002-332
BVV-6	154	78	150	108	420	22	183	228	2800	14	1002-333
BVV-8	205	87	200	115	500	22	202	238	3000	18	1002-334
BVV-10	253	100	250	114	570	22	220	263	3000	24	1002-335

mm



# Quick Bench Vise

ORDER NO.VQS-40 CODE NO.1002-096

NEW



QUICK ACTION HANDLE

- Hardened & Ground Jaw
- Jaw Width 100 mm
- Jaw Height 29 mm
- Opened Capacity 100 mm
- 8 mm Distance of Quick Clamping System
- Can Be Move By Handle & By Quick Action Arm
- Weight: 13.3 kgs

