



# Hydraulic Machine Vise

HYDRO + MECHANICAL

PAT.

Power Build Out Type



HYDRAULIC MACHINE VISE



HYDRO FORCE INDICATOR  
A→H

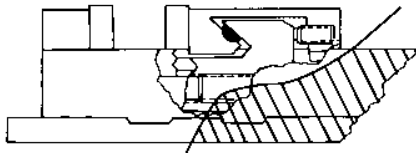
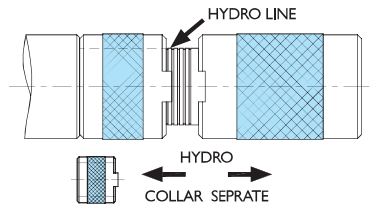
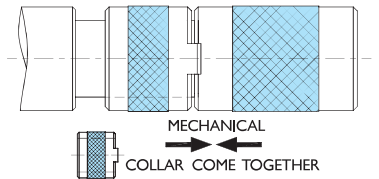

SUIT FOR PROCESSING OF  
BRASS, AL, PLASTIC, STEEL,  
CASTING

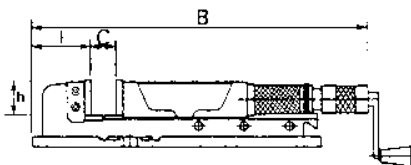
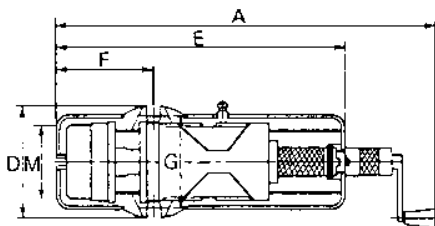

### Features

- Hydro : move the spindle ring until see the hydro line to work vise.
- Mechanical : move the spindle ring toward the end until the bushing close the hydro line.
- Heavy duty cutting.
- Hardness > HRC 45° : vise sliding bed.
- High durability & high precision.
- Tolerance : 0.01/100mm
- Lift proof : press down design.
- FCD 60 with 60 kgs/mm<sup>2</sup> or 80,000 psi high quality ductile cast iron - body material - reduce the cutting vibration.

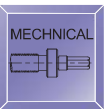

### VHO-VISE

ORDER NO.	A	B	C OPEN	D	E	F	G	I	M	h	Jaw w	Max. Clamp Force (kgf)	N.W. (kgs)	CODE NO.
VHO-5	695 920	545 775	0-220	190	505	180	160	105	130	55	130	3500	36.5	1002-220
VHO-6	750 1060	600 915	0-300	240	625	208	196	125	160	58	160	4000	59.1	1002-221
VHO-8	830 1140	700 1015	0-310	280	700	265	240	165	200	63	200	5000	94.3	1002-228

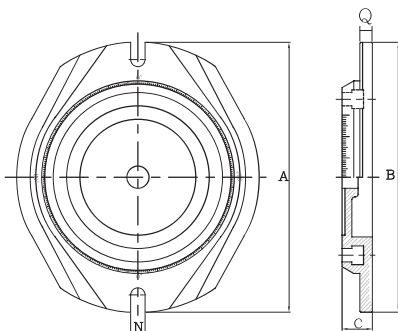

### Optional : Swivel Base

ORDER NO.	A	B	C	N	N.W. (kgs)	CODE NO.
HSO-5	285	263	35	16	12.5	1002-222
HSO-6	330	320	40	18	16.5	1002-223
HSO-8	415	413	50	21	35	1002-229

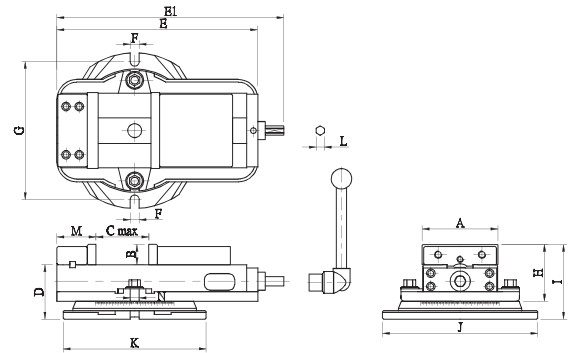
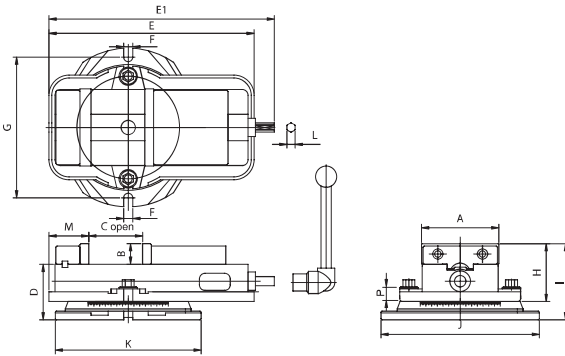

- The enclosed lead screw and sliding surface are harden and ground.
- Highest clamping power. It's very accurate and durable.
- This Vise is so designed that the horizontal Force generated by tightening the handle pushes the semisphere within the movable jaw and thus thrusts the movable jaw downward - angle lock feature.
- There fore, the workpiece does not lift, even if it is held at the top of the jaw plates.
- Four setting positions of the jaw plates are available, widening the jaw plates opening.
- ACCURACY WITHIN 0.02mm
- Mini order quantity : 3 sets for same height by request.
- In order to ensure the accurence when using it' better that don't put swivel base together

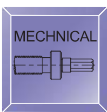
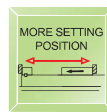

## Order No. & Dimensions

ORDER NO.	A	B	C OPEN	D	E	E1	F	G	H	I	J	K	L	M	N	P	MAX. Clamp Force (kgf)	G.W. (KG)	C.F.T. (CM)	CODE NO.
VA-4	106	36	103	90	324	351	13	211	96	126	242	228	14.5	75	16	15	1500	20	35x24x15	1002-030
VA-5	135	36	110	97	359	394	17	246	101	133	277	255	14.5	85	16	15	2000	30	41x31x17	1002-031
VA-6	155	46	150	110	422	452	20	288	118	158	326	302	19	95	16	17	2500	42	49x35x20	1002-032
VA-8	210	60	197	129	553	583	19	355	145	190	395	366	19	105	16	19	3000	80	63x41x24	1002-033
VD-675	160	49	190	110	445	478	19	296	121	160	333	305	19	80	16	17	2500	42	52x35x21	1002-034
<b>NEW</b> VD-690	155	46	230	110	450	480	20	288	118	158	326	302	19	67	16	17	2300	43	49x35x20	1002-034B
<b>NEW</b> VD-810	205	62	275	129	555	615	19	378	147	191	420	377	19	79	16	17	3000	76	63x41x24	1002-035B

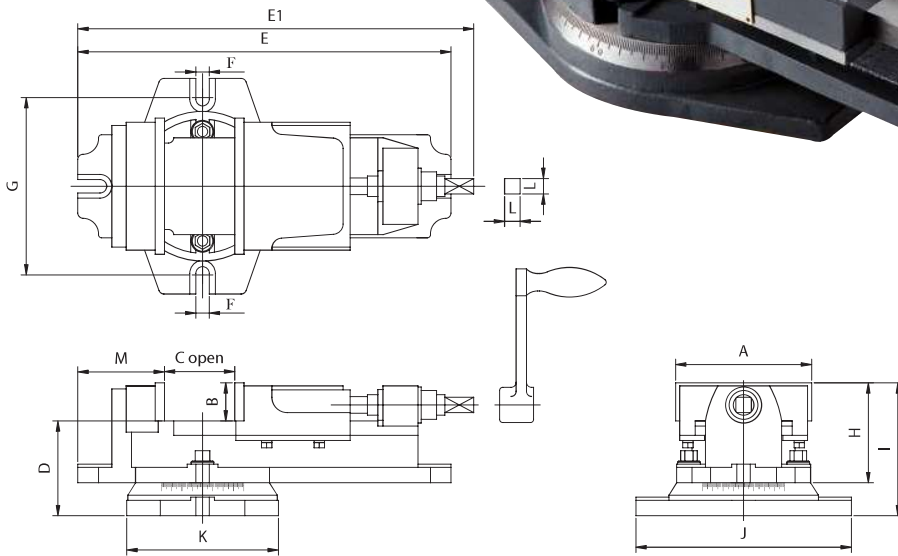

- It's a practical piece of equipment with excellent precision and a high quality finished.
- Body, movable jaw and swivel base made of closes-grained high tensile iron castings. Built for machining and retained accuracy.
- Jaw plates were made of hardened and grounded tool steel.
- It's the most suitable for the Milling, Grinding and Drilling.
- ACCURACY WITHIN 0.02mm
- In order to ensure the accuracy when using it' better that don't put swivel base together.

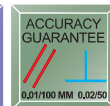
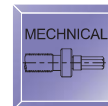

## Order No. & Dimensions

ORDER NO.	A	B	C OPEN	D	E	E1	F	G	H	I	J	K	L	M	Max. Clamp Force (kgf)	G.W. (kgs)	C.F.T. (cm)	CODE NO.
VK-4	104	36	62	76	293	310	13	145	83	113	176	122	15	65	900	10	33x13x13	1002-040
VK-5	132	37	80	92	362	384	13	172	97	129	209	147	15	84	900	16	40x16x15	1002.041
VK-6	154	43	112	105	442	473	15	209	108	148	260	181	16.5	90	1000	27	51x22x19	1002-042
VK-8	204	63	146	127	579	609	18	312	148	190	350	234	21	122	1400	59	65x27x25	1002-043