

Tooling blocks

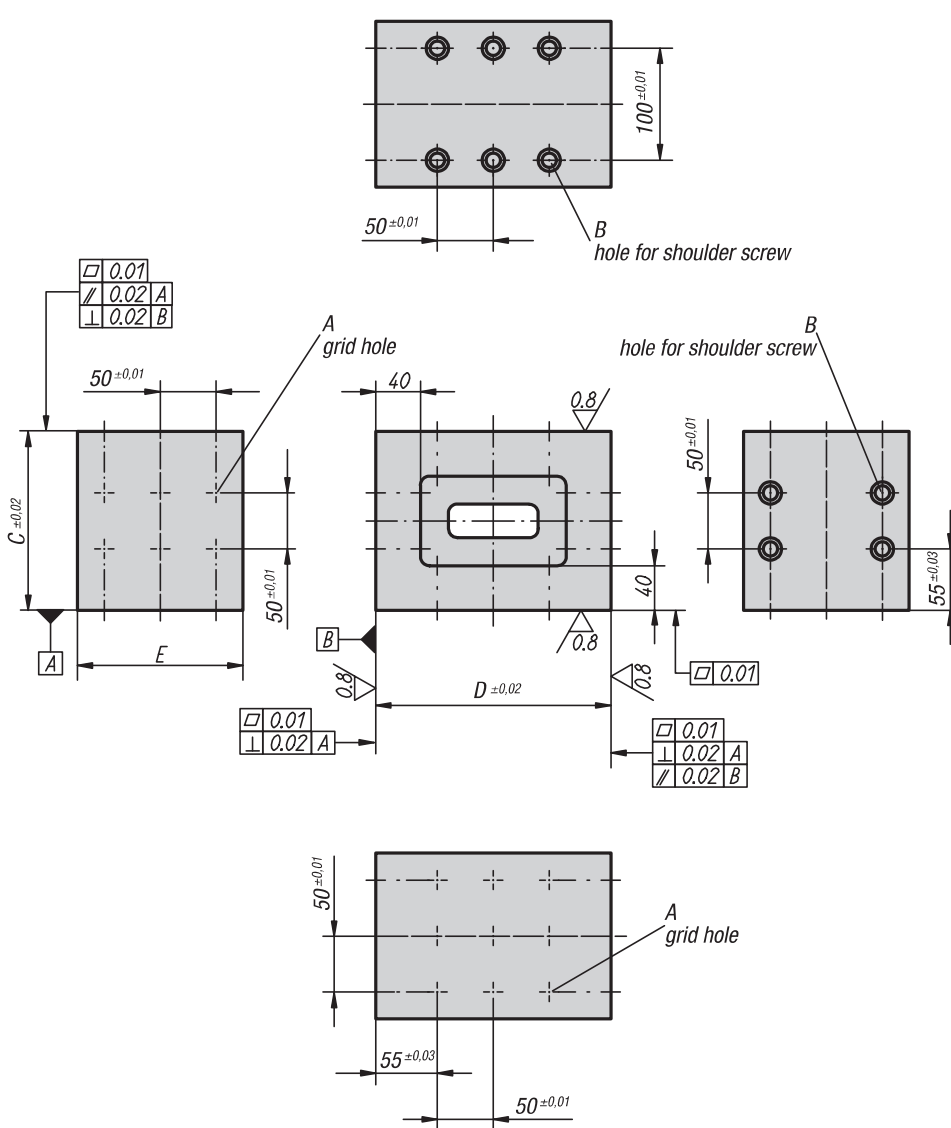

Material:

GJL 300

Version:

Support and mounting surfaces ground

Sample order:

K0809.090121621

Note:

Grid hole pitch 50 ± 0.01 mm.

Tooling blocks can be used for mounting low workpieces or as small bases. They can also be used as parallel gauge blocks for inspection work.

Tooling blocks K0809.090121621 and K0809.090122126 mounted with shoulder screws K0815.112065.

Tooling blocks K0809.090161621 and K0809.090162126 mounted with shoulder screws K0815.16075.

KIPP Tooling blocks

Order No.	A locating hole	A thread	B \varnothing for shoulder screw	C	D	E	No. of grid holes	No. of mounting holes	weight kg
K0809.090121621	12 F7	M12	12 F7	160	210	148	15	10	27,34
K0809.090122126	12 F7	M12	12 F7	210	260	148	21	14	37
K0809.090161621	16 F7	M16	16 F7	160	210	148	15	10	25
K0809.090162126	16 F7	M16	16 F7	210	260	148	21	14	36

Mini tooling blocks



Material:

GJL 300

Version:

Support and mounting surfaces ground

Sample order:

K0809.09512125

Note:

Mini tooling blocks are positioned using 2 locating pins K0817 and secured with 2 DIN 912 cap screws. They can be used as stops or support and add-on elements.

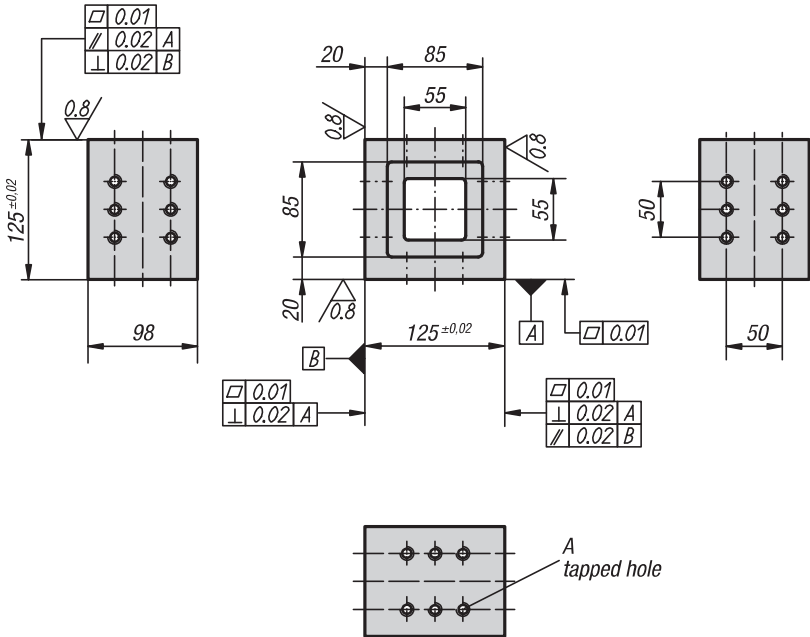
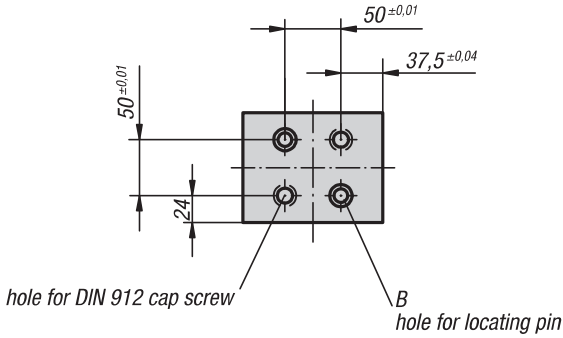

KIPP Mini tooling blocks

Order No.	A	B	C hole for DIN 912 cap screw	suitable locating pins	weight kg
K0809.09512125	M12	12 F7	M12	K0817.12	6.08
K0809.09516125	M16	16 F7	M16	K0817.16	6.081

Riser blocks

Form H

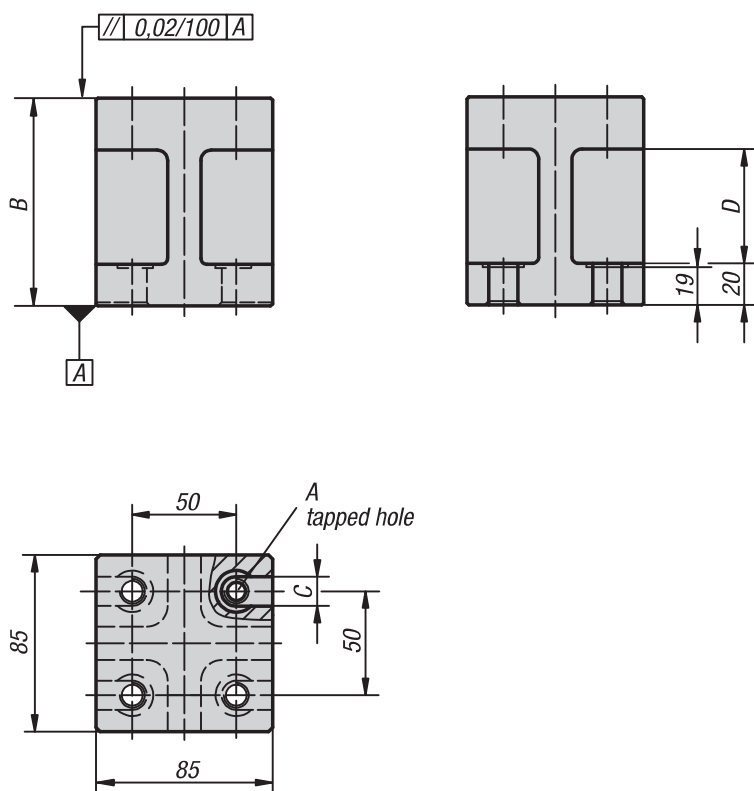

Material:
GJL 300

Version:
Black oxidised.

Sample order:
K0811.33012100

Note:
Form H riser blocks are mounted using DIN 912 socket head screws.

KIPP Riser blocks Form H

Order No.	A	B	C	D	weight kg
K0811.33012100	M12	100	14	55	3,52
K0811.33012125	M12	125	14	80	4
K0811.33016100	M16	100	18	55	3,36
K0811.33016125	M16	125	18	80	3,86

Fastening blocks

Form M

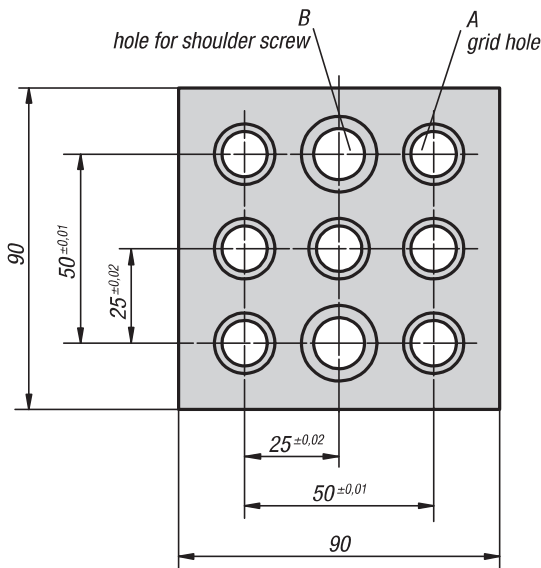
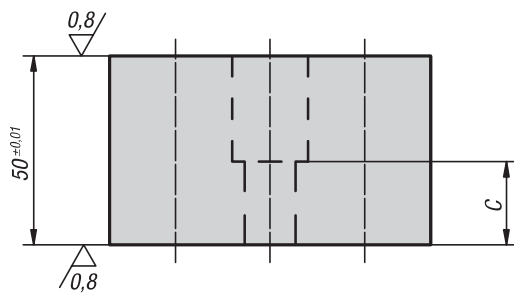

Material:

Carbon steel.

Version:

Black oxidised.
Contact faces ground.

Sample order:

K0810.12112050

Note:

Fastening blocks are used as risers for all system elements which have no movable seating faces - these include locating supports K0816, vertical V-blocks K0819.600.

They also allow positioning and fastening elements within a 50 ± 0.01 mm pitch (see application example).

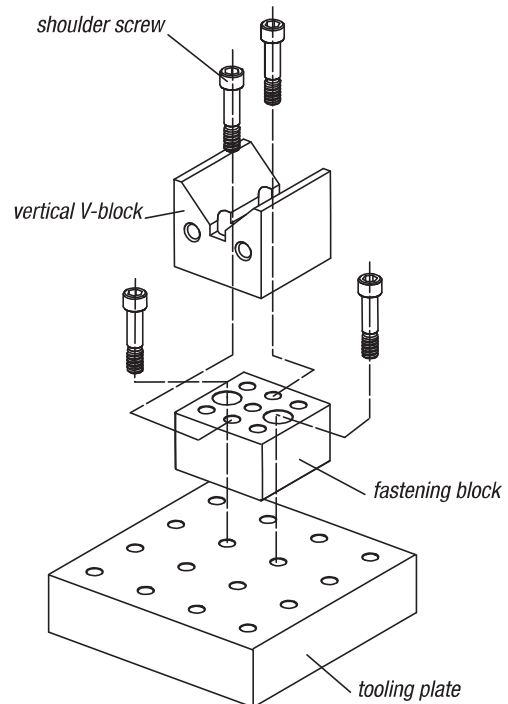

KIPP Fastening blocks Form M

Order No.	A locating hole	A thread	B Ø for shoulder screw	C	No. of grid holes	No. of mounting holes	Suitable shoulder screw	weight kg
K0810.12112050	12 F7	M12	12 F7	22	7	2	K0815.112055	2.693
K0810.12116050	16 F7	M16	16 F7	26	7	2	K0815.116055	2.355

Precision riser blocks

Form D

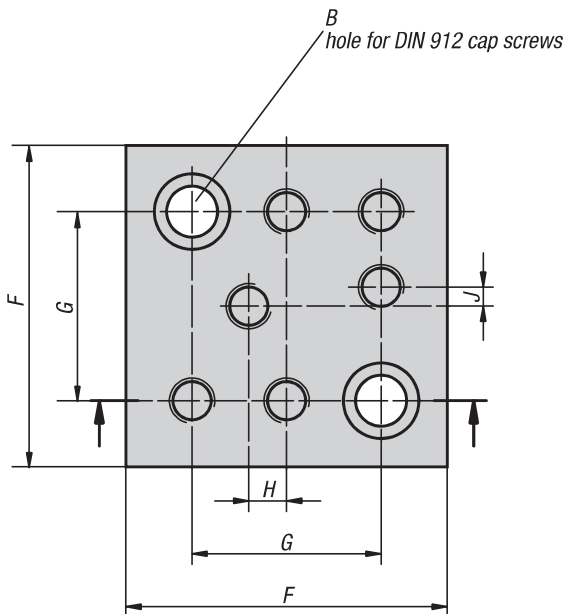
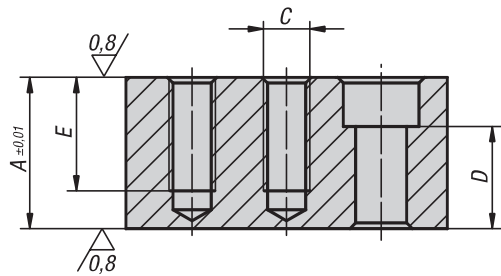

Material:

Carbon steel.

Version:

Black oxidised.

Contact faces ground.

Sample order:

K0811.14012025

Note:

Riser blocks are used to achieve a certain support height. The additional tapped holes in the risers are for mounting further fixture elements.

KIPP Precision riser blocks Form D

Order No.	A	B hole for DIN 912 screw	C	D	E	F	G	H	J	weight kg
K0811.14012025	25	M12	M12	12	25	85	50	10	5	1.218
K0811.14012032	32	M12	M12	19	32	85	50	10	5	1.56
K0811.14012040	40	M12	M12	27	30	85	50	10	5	1.97
K0811.14012050	50	M12	M12	37	30	85	50	10	5	2.5
K0811.14016025	25	M16	M16	8	25	85	50	10	5	1.039
K0811.14016032	32	M16	M16	15	32	85	50	10	5	1.33
K0811.14016040	40	M16	M16	23	35	85	50	10	5	1.7
K0811.14016050	50	M16	M16	33	35	85	50	10	5	2.123

Precision riser blocks

Form M



Material:

Carbon steel.

Version:

Black oxidised.
Contact faces ground.

Sample order:

K0811.14112025

Note:

Riser blocks are used to achieve a certain support height. The additional tapped holes in the risers are for mounting further fixture elements.

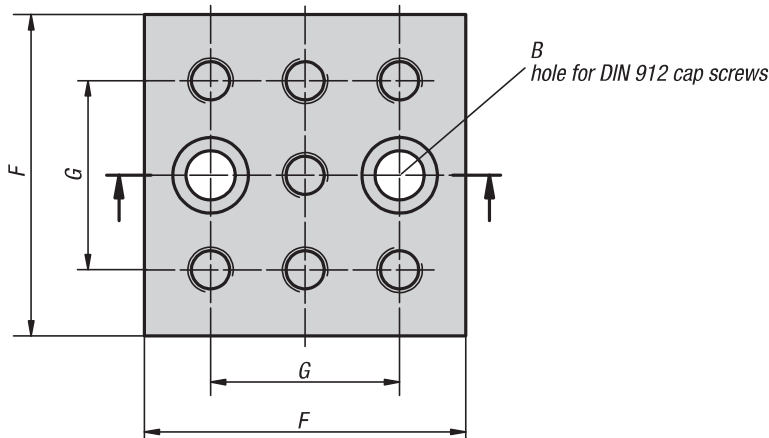
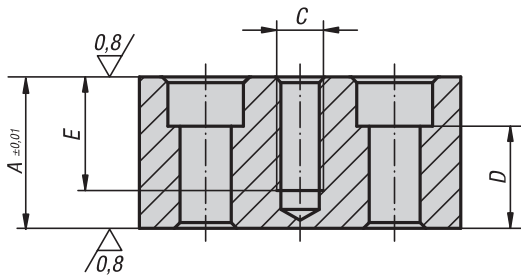

KIPP Precision riser blocks Form M

Order No.	A	B hole for DIN 912 screw	C	D	E	F	G	weight kg
K0811.14112025	25	M12	M12	12	25	85	50	1.199
K0811.14112032	32	M12	M12	19	32	85	50	1.535
K0811.14112040	40	M12	M12	27	30	85	50	1.955
K0811.14112050	50	M12	M12	37	30	85	50	2.43
K0811.14116025	25	M16	M16	8	25	85	50	1.007
K0811.14116032	32	M16	M16	15	32	85	50	1.31
K0811.14116040	40	M16	M16	23	35	85	50	1.653
K0811.14116050	50	M16	M16	33	35	85	50	2.104

Precision riser blocks

Form E



Material:
Carbon steel.

Version:
Black oxidised.
Contact faces ground.

Sample order:
K0811.14212025

Note:
Riser blocks are used to achieve a certain support height. The additional tapped holes in the risers are for mounting further fixture elements.

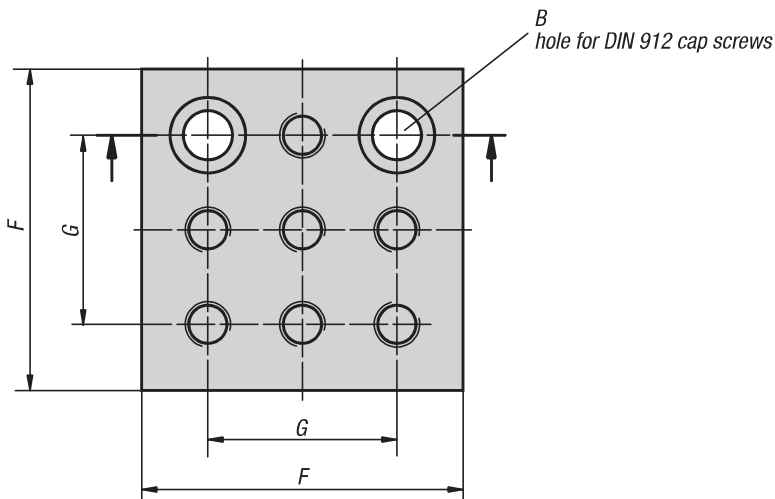
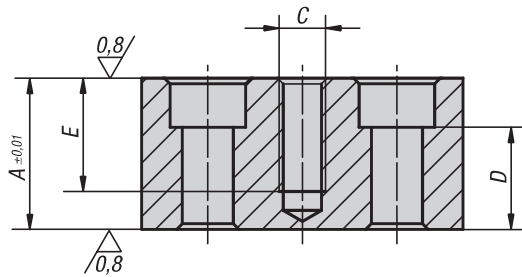

KIPP Precision riser blocks Form E

Order No.	A	B hole for DIN 912 screw	C	D	E	F	G	weight kg
K0811.14212025	25	M12	M12	12	25	85	50	1.208
K0811.14212032	32	M12	M12	19	25	85	50	1.52
K0811.14212040	40	M12	M12	27	30	85	50	1.95
K0811.14212050	50	M12	M12	37	30	85	50	2.454
K0811.14216025	25	M16	M16	8	25	85	50	1.005
K0811.14216032	32	M16	M16	15	32	85	50	1.289
K0811.14216040	40	M16	M16	23	35	85	50	1.68
K0811.14216050	50	M16	M16	33	35	85	50	2.18

Round positioning plates

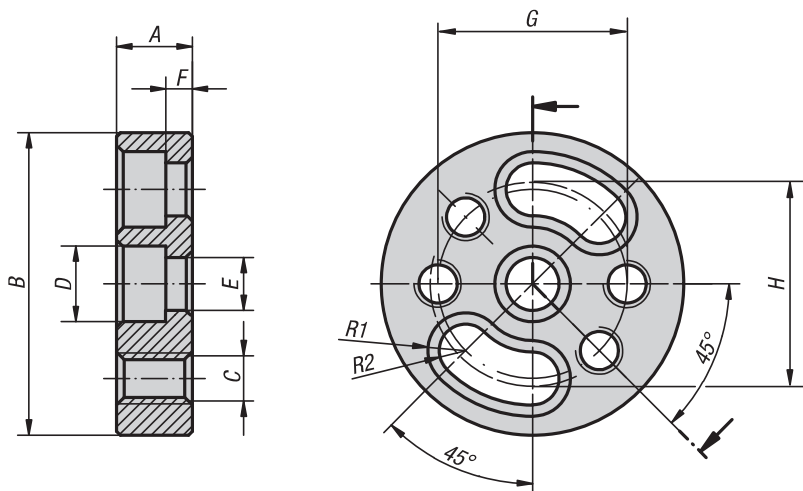

Material:

Carbon steel.

Version:

Black oxidised.

Sample order:

K0812.24212020

Note:

Round positioning plates allow clamps such as K0853.920 and K0853.930 to be positioned against the workpiece at an angle of e.g. 30°. The rack plates CL K0853.940 are mounted on the round positioning plate as intermediate adapters, the clamps are fitted and rotated to the correct position.

KIPP Round positioning plates

Order No.	A	B	C	D	E	F	G	H	R1	R2	weight kg
K0812.24212020	20	80	M12	20	14	7	50	50	10	7	0.49
K0812.24216025	25	100	M16	26	18	7	50	70,7	13	9	0.867