

**EARTH-CHAIN****Power that works.**

Electro-Permanent Magnetic Chuck-Connection Type EEPM-C Series

Suitable for use on large Vertical Lathe, Double Column Machining Center and CNC Machining Center ...etc.



Each voltage with two specifications can be choice:

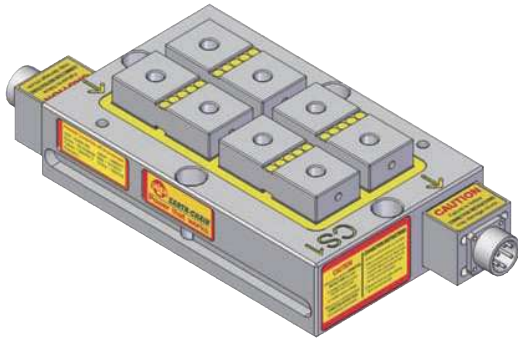

EEPM-2030C-220V Series

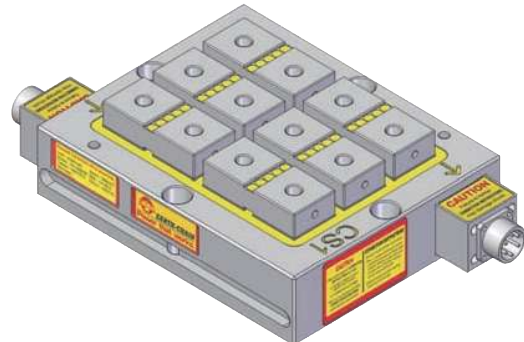

EEPM-2530C-380V~440V Series

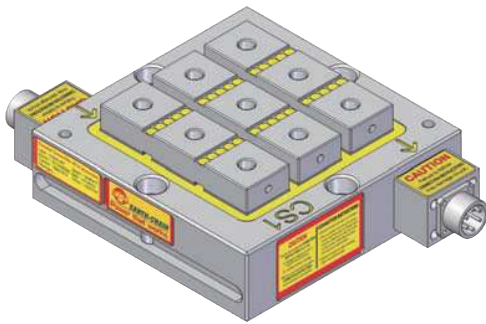

EEPM-2525C-220V Series

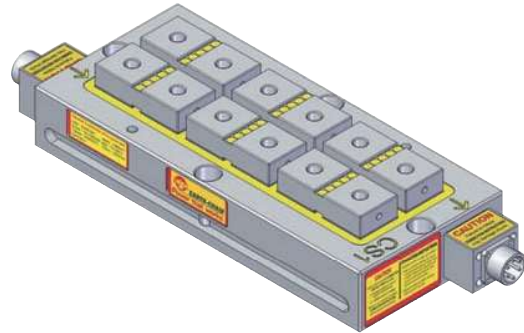

EEPM-2040C-380V~440V Series

Features:

1. Super power magnetic force 1250 kgf/100 cm (4 poles), can meet various machining process.
2. Structure of Electro-Permanent Magnetic Chuck, no electric power supply required to keep the chuck On, it could be used for long time and never get temperatures to affect the accuracy of workpiece.
3. Using innovation series and parallel connection modular system, EEPM-C provides a more economic solution to hold various size workpiece. Flexible units could be deployed with various quantities, locations, and distance to each other depending on customers' various workpiece shapes. Save time and cost during machining and increase the accuracy that makes the goods have higher quality and value.
4. According to the size of the workpiece [point] hold the workpiece, changing the magnetic fixture [surface] clamp the workpiece, 100% use of the chuck in an all-round way. Can reduce equipment costs and increase more profits.
5. Without any obstructed movement of cutters during machining. Can do 5-sides machining, drilling, tapping, grooving and forming can be done all in one cycle. This greatly enhances work efficiency, and reduces repeated positioning tolerances to achieve best machining accuracy.

How to choose:

According application requirement can choose EEPM-C Series as following steps:

1. Choose number of chucks according to Voltage and workpiece required.
2. Choose Chuck Controller.
3. Choose the length of Chuck Connection Cables.
4. Choose the Screw Size.
5. Choose the length of Power Cord.

Note: A maximum of 16 chucks can be connected to one controller. If the workpiece dimension requests more than 16 chucks please use two groups of chucks unit.

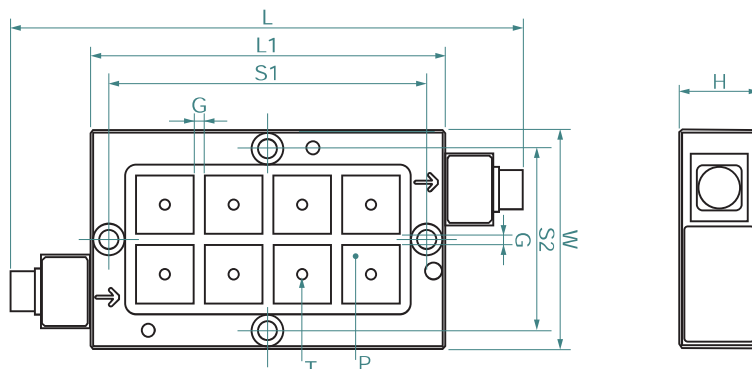
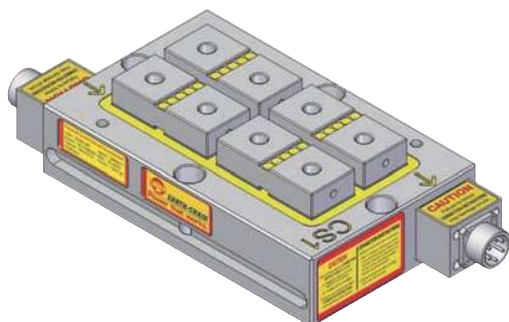

EEPM-2030C-220V Series

Unit: mm

MODEL NO	VOLTAGE (Single Phase)	DIMENSION							PITCH G	POLE P	NO. OF POLE	HOLDING POWER	CHUCK N.W.
		W	L	L1	S1	S2	H	T					
EEPM-2030CS1	DC 220V	190	440	310	280	160	70	M8	10	50×50	8	2500±5%	33.5kg
EEPM-2030CS2													
EEPM-2030CS3													
EEPM-2030CS4													

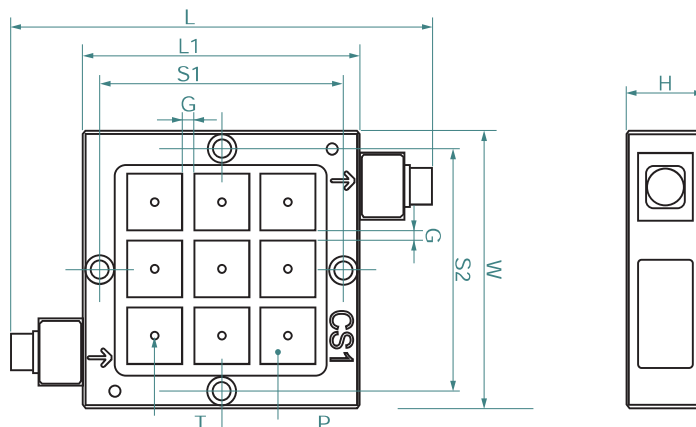
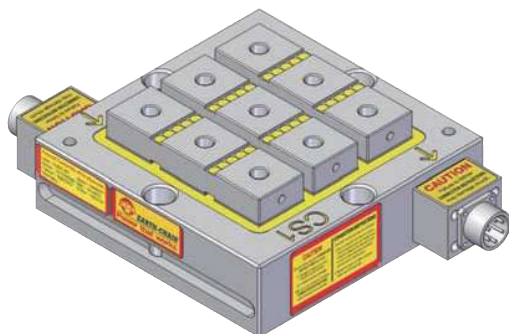

EEPM-2525C-220V Series

Unit: mm

MODEL NO	VOLTAGE (Single Phase)	DIMENSION							PITCH G	POLE P	NO. OF POLE	HOLDING POWER	CHUCK N.W.
		W	L	L1	S1	S2	H	T					
EEPM-2525CS1	DC 220V	250	380	250	220	220	70	M8	10	50×50	9	2800±5%	35.0kg
EEPM-2525CS2													
EEPM-2525CS3													
EEPM-2525CS4													

**EARTH-CHAIN****Power that works.**

Electro-Permanent Magnetic Chuck-Connection Type Voltage 380V~440v Series

Suitable for use on large Vertical Lathe, Double Column Machining Center and CNC Machining Center ...etc.

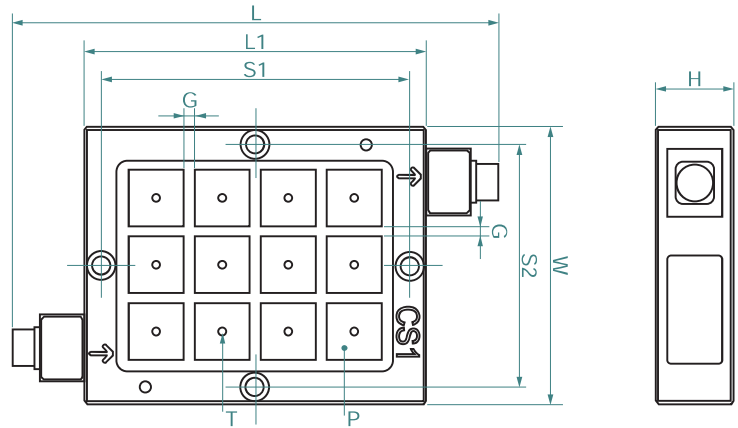
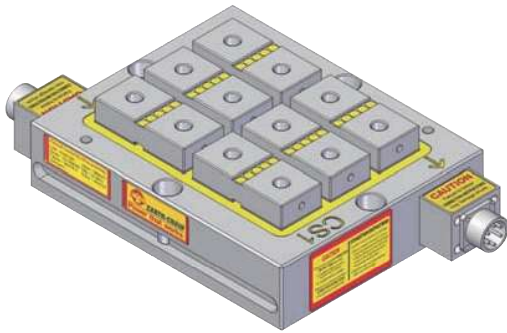
**EEPM-2530C-380V~440V Series**

Unit: mm

MODEL NO	VOLTAGE (Single Phase)	DIMENSION							PITCH G	POLE P	NO. OF POLE	HOLDING POWER	CHUCK N.W.
		W	L	L1	S1	S2	H	T					
EEPM-2530CS1 EEPM-2530CS2 EEPM-2530CS3 EEPM-2530CS4	DC 380V ~ 440V	250	440	310	280	220	70	M8	10	50×50	12	3750±5%	44.0kg

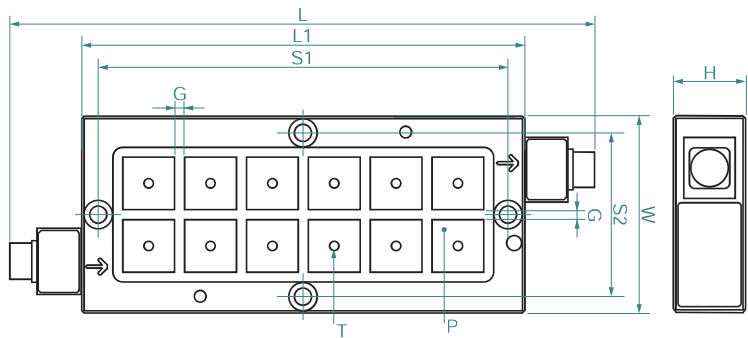
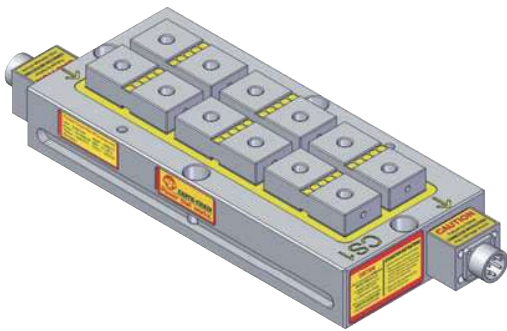
**EEPM-2040C-380V~440V Series**

Unit: mm

MODEL NO	VOLTAGE (Single Phase)	DIMENSION							PITCH G	POLE P	NO. OF POLE	HOLDING POWER	CHUCK N.W.
		W	L	L1	S1	S2	H	T					
EEPM-2040CS1 EEPM-2040CS2 EEPM-2040CS3 EEPM-2040CS4	DC 380V ~ 440V	190	560	430	400	160	70	M8	10	50×50	12	3750±5%	41.0kg



Chuck Controller EEPM-C4C



The controller EEPM-C4C can be controlled for 1 to 4 piece of EEPM-CS1 、CS2 、CS3 、CS4 at same time and with detection abnormal function.

Unit: mm

MODEL NO	VOLTAGE (Single Phase)	DIMENSION			CONNECTION AVAILABLE
		L	W	H	
EEPM-C4C	AC 220V / AC 380V~440V	370	220	125	3~16 Chucks (CS1x1~4 pcs, CS2x1~4 pcs, CS3x1~4 pcs, CS4x1~4 pcs)

Standard Accessories: Induction soft block

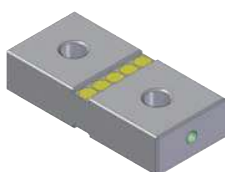

EEPM-IB225

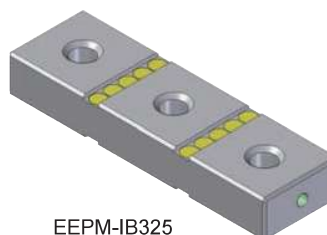

EEPM-IB325

Convenience and Accuracy:

The induction blocks screwed on the magnetic chuck are replaceable and consumable accessories. You can fine grinding the surface or forming induction blocks according to requirements of workpiece by the machine directly that the parallelism of induction blocks can be 100% with the machine and the 5-sided machining can be easily conducted.

Standard accessories (Screw Size)

T-Slot	A	B	C	D	F	Thread
18	18 ⁺⁰ _{-0.3}	20	11	28	32	5/8"-11
22	20 ⁺⁰ _{-0.3}	26	14	32	38	5/8"-11
28	26 ⁺⁰ _{-0.3}	26	16	41	40	5/8"-11

Chuck installation direction:

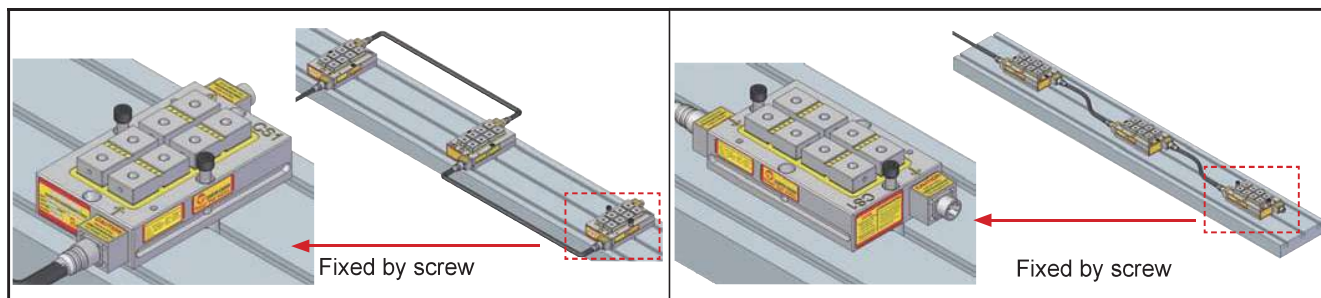

**EARTH-CHAIN****Power that works.**

Electro-Permanent Magnetic Chuck-Connection Type EEPM-C Series

Suitable for use on large Vertical Lathe, Double Column Machining Center and CNC Machining Center ...etc.



Chuck Connection Cable

Standard Accessories - (Iron Flexible Conduit)

Suitable for general machining.



MODEL NO	LENGTH
EEPM-CC03	300mm
EEPM-CC05	500mm
EEPM-CC10	1000mm
EEPM-CC15	1500mm

Optional Accessories – (Stainless Steel Flexible Conduit)

Suitable for long time heavy duty machining.
With high toughness and high strength preventing iron chips cut off the wire.



MODEL NO	LENGTH
EEPM-CC05B	500mm
EEPM-CC10B	1000mm
EEPM-CC15B	1500mm

CONNECTION TABLE

MODEL NO	EEPM-2030C 220V			EEPM-2525C 220V			EEPM-2530C 380V~440V			EEPM-2040C 380V~440V		
CHUCK NOS.	HOLDING POWER OF EACH CHUCK	TOTAL HOLDING POWER kgf ±5%	CURRENT AMP	HOLDING POWER OF EACH CHUCK	TOTAL HOLDING POWER kgf ±5%	CURRENT AMP	HOLDING POWER OF EACH CHUCK	TOTAL HOLDING POWER kgf ±5%	CURRENT AMP	HOLDING POWER OF EACH CHUCK	TOTAL HOLDING POWER kgf ±5%	CURRENT AMP
3	2500±5%	7500	7A	2800±5%	8400	7A	3750±5%	11250	8A	3750±5%	11250	8A
4		10000	9A		11200	9A		15000	10A		15000	10A
5		12500	11A		14000	10A		18750	12A		18750	12A
6		15000	12A		16800	11A		22500	13A		22500	13A
7		17500	14A		19600	12A		26250	16A		26250	16A
8		20000	16A		22400	14A		30000	18A		30000	18A
9		22500	17A		25200	15A		33750	19A		33750	19A
10		25000	19A		28000	17A		37500	21A		37500	21A
11		27500	20A		30800	19A		41250	23A		41250	23A
12		30000	22A		33600	20A		45000	25A		45000	25A
13		32500	24A		36400	22A		48750	27A		48750	27A
14		35000	26A		39200	23A		52500	29A		52500	29A
15		37500	27A		42000	24A		56250	30A		56250	30A
16		40000	29A		44800	26A		60000	33A		60000	33A

If the workpiece dimension requests more than 16 chucks, please use two groups of chuck unit.

Notice:

- EEPM-C Series each voltage has two specifications can be choose, each specification has four models EEPM-CS1, CS2, CS3 and CS4 can be connected but each model can be up to 4 units only.
- The controller EEPM-C4C can be controlled EEPM-CS1, CS2, CS3 and CS4 each of them 4 pieces at same time.
- Maximum distance required:

No. of EEPM-CS	3-4 Chucks	5-10 Chucks	11-16 Chucks
Max. Distance Between Chucks	800 mm	1000 mm	1500 mm



Example of Vertical Lathe on Setting:

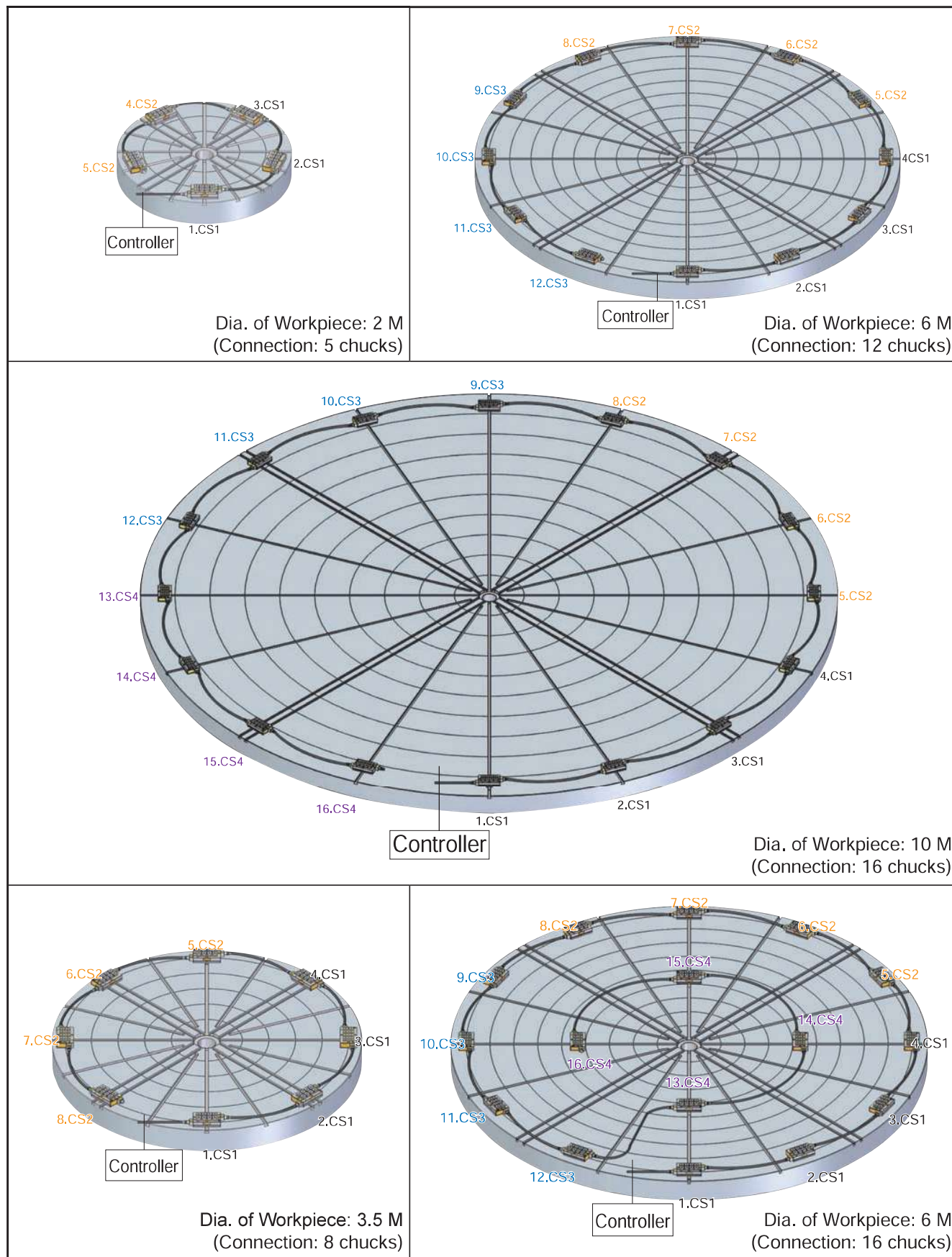



EARTH-CHAIN

Power that works.

Electro-Permanent Magnetic Chuck-Connection Type EEPM-C Series

Suitable for use on large Vertical Lathe, Double Column Machining Center and CNC Machining Center ...etc.



Example of Double Column Machining Center and CNC Machining Center on Setting

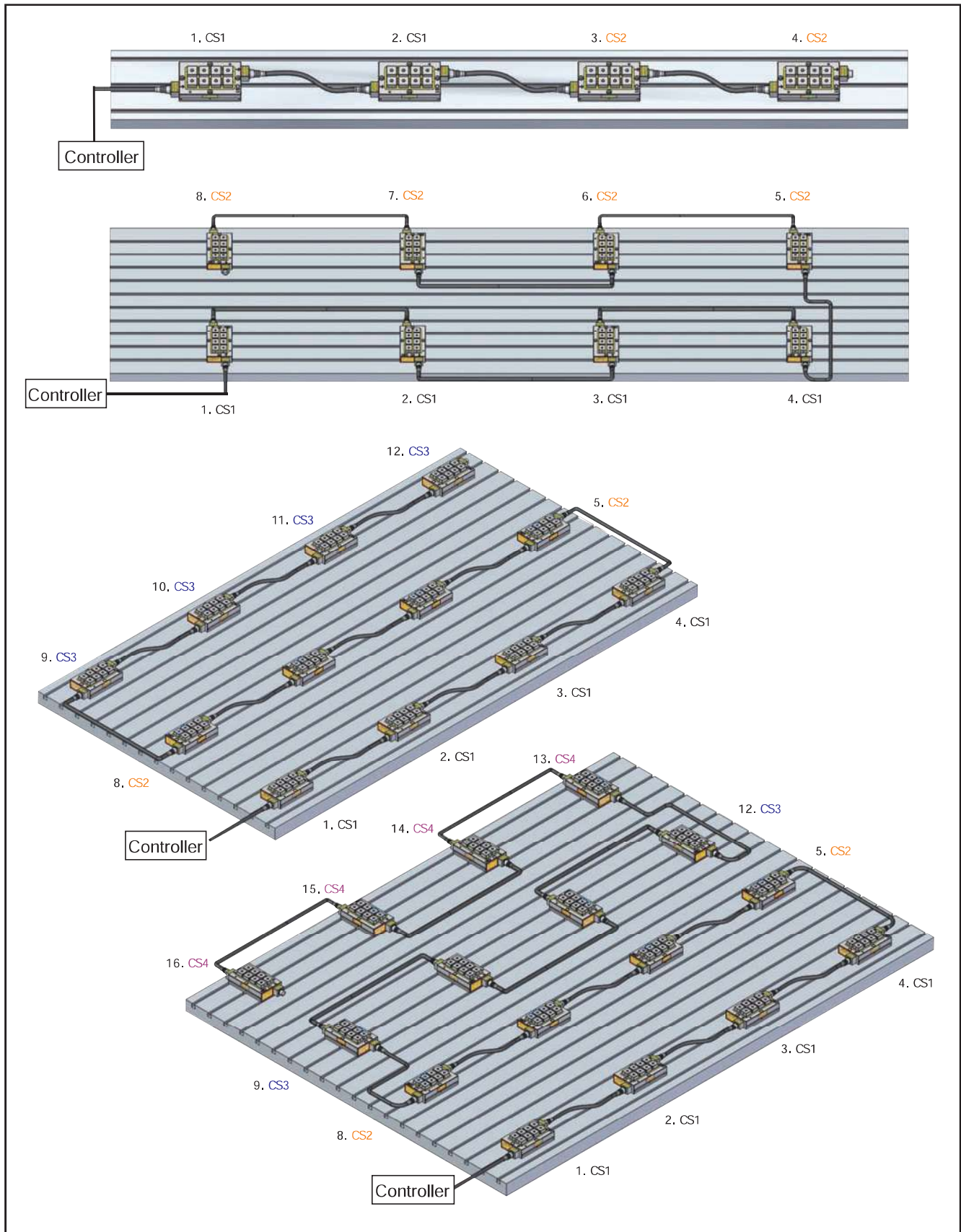



Working Example

